

- When the pump shaft (part 1) is inserted into the pump body, the cylindrical surface at the insertion end shall be coated with white grease.
- The hexagon head bolt (part 8) shall be coated with thread locking glue (medium strength). When tightening, the force shall not be too large, but sufficient tightening shall be ensured.
- When tightening the hexagon head bolt (part 11), the force should not be too large, but enough tightening should be ensured.

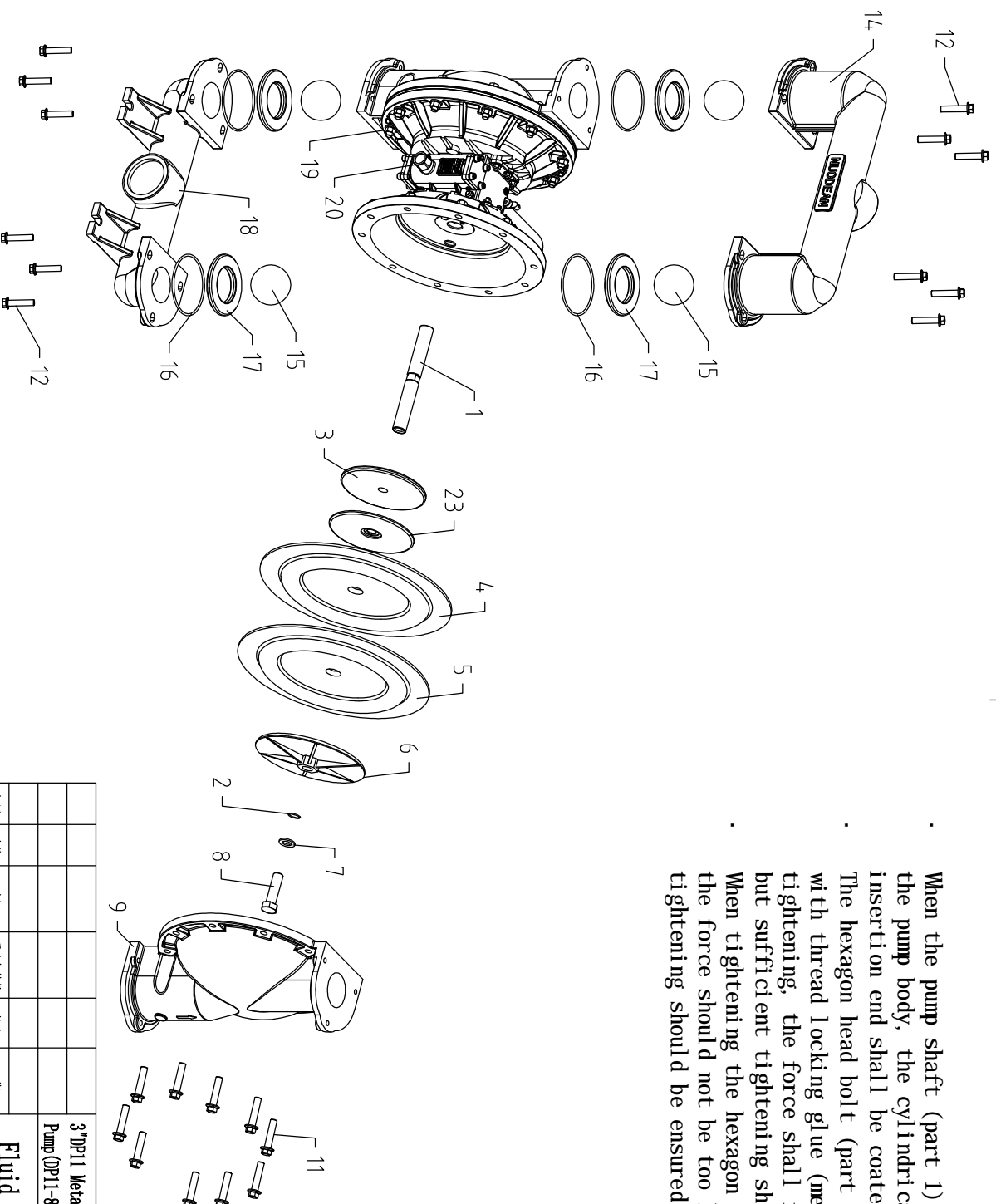

3" DP11 Metallic Diaphragm Pump (DP11-80BXXXXXX)				NUODEAN PUMP CO., LTD			
Fluid Section							
标记	页数	分区	更改文件号	签名	日期	拆段标记	质量
设计			标准化				比例
审核							1:1
工艺			批准			共 张	第 张

NDA-PZP103



3" DP11 Metallic Diaphragm Pump(DP11-80BXXXXXX)

Part List Of Fluid Section

Posit	Part Name	Part No.	Material	Quantity	
1	Rod	NDA-PD69	Stainless Steel	1	
2	O Ring	Y328-210	PTFE(white)	2	
3	Plate-air side	94831-1	Carbon Steel	2	
4	Backer Diaphragm	96477-A	Green Santoprene	2	Used as a backer when No.5 is PTFE(white) Diaphragm
5	Diaphragm	96475-G	Nitrile	2	
		96476-T	PTFE	2	
		96475-C	Hytrel	2	
		96475-A	Santoprene	2	
6	Plate-Fluid side	94802	Aluminum	2	
		94803	Stainless Steel	2	
7	Washer	Y13-12-T	Stainless Steel	2	
8	Bolt		Stainless Steel	2	
9	Fluid Cap	96430	Aluminum	2	
		96650	Stainless Steel	2	
		96638	Cast Iron	2	
11	Bolt		Steel	20	
			Stainless Steel	20	
12	Bolt		Steel	8	
			Stainless Steel	8	
14	Outlet Manifold	NDA-PC80	Aluminum	1	
		NDA-PC136	Stainless Steel	1	
		NDA-PC138	Cast Iron	1	
15	Ball (82.55mm)				
		94103-G	Nitrile	4	
		94103-T	PTFE	4	
		94103-C	Hytrel	4	
16	O Ring				
		94103-A	Santoprene	4	
		Y325-350	Nitrile	4	
		Y327-350	Viton	4	
17	Seat	Y328-350	PTFE	4	
		95674	Aluminum	4	
		94113	Stainless Steel	4	
		94104-A	Santoprene	4	
18	Inlet Manifold	94104-G	Nitrile	4	
		95678	Carbon Steel	4	
		PC79	Aluminum	1	
		PC135	Stainless Steel	1	
19	Nut	PC137	Cast Iron	1	
			Carbon Steel	20	
20	Adapter	NDA-PU05	Stainless Steel	1	
21	Plastic Cap	NDA-PU07		2	
22	Plastic Cap	NDA-PU06		1	
23	Cusion	94631		1	