

• When the pump shaft (part 1) is inserted into the pump body, the cylindrical surface at the insertion end shall be coated with white grease.
 • The hexagon head bolt (part 8) shall be coated with thread locking glue (medium strength). When tightening, the force shall not be too large, but sufficient tightening shall be ensured.
 • When tightening the hexagon head bolt (part 11), the force should not be too large, but enough tightening should be ensured.

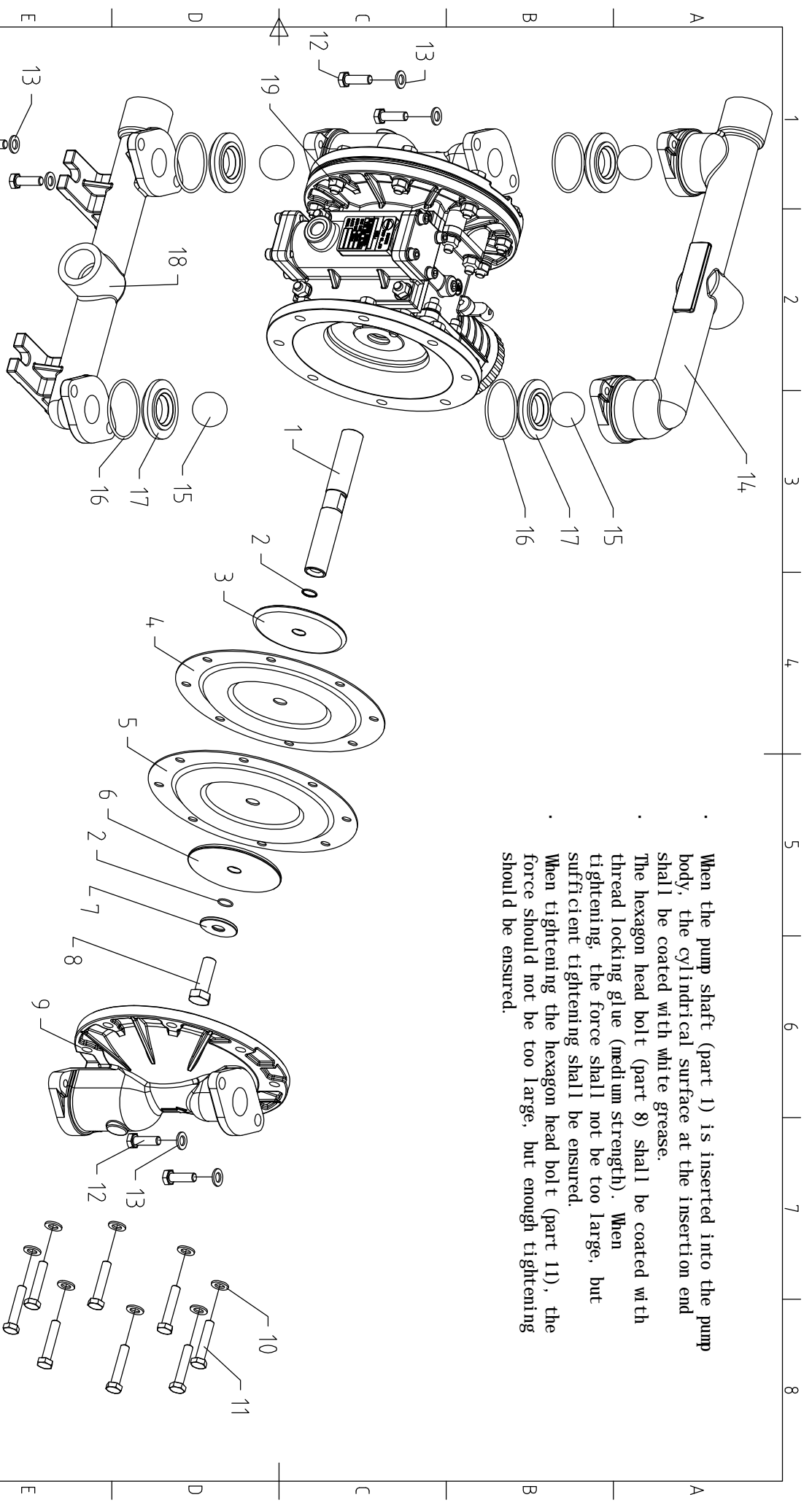

				1"DP11 Old Type Metallic Diaphragm Pump (DP11-25BXXXXXX-Old Type)				NUODEAN PUMP CO., LTD	
Fluid Section									
标记	页数	分区	更改文件号	签名	日期	标识标记	质量	比例	
设计			标准化					1.5:1	
审核									
工艺			批准						
							共 张	第 张	

NDA-PZP104



1"DP11 Old Type Metallic Diaphragm Pump(DP11-25BXXXXXX-Old Type)

Part List Of Fluid Section

Position	Part Name	Part No.	Material	Quantity	
1	Rod	NDA-PD66	Stainless Steel	1	
2	O Ring	Y328-14	PTFE	4	
3	Plate-air side	93441-2	Carbon Steel	2	
4	Backer Diaphragm	92973-B	Green Santoprene	2	Used as a backer when No. 5 is PTFE(white) Diaphragm
5	Diaphragm	90533-1	Neoprene	2	
		90533-2	Nitrile	2	
		90533-3	Viton	2	
		93459-4	PTFE(white)	2	
		90533-9	Hytrel	2	
		90533-B	Yellow Santoprene	2	
6	Plate-Fluid side	93441-1	Stainless Steel	2	
7	Washer	NDA-PN70	Stainless Steel	2	
8	Bolt	NDA-PX20	Stainless Steel	2	
9	Fluid Cap	NDA-PB68	Aluminum	2	
		NDA-PB74	Stainless Steel	2	
10	Washer	NDA-PX21	Carbon Steel	16	
		NDA-PX22	Stainless Steel	16	
11	Bolt	NDA-PX23	Carbon Steel	16	
		NDA-PX24	Stainless Steel	16	
12	Bolt	PX25	Carbon Steel	8	
		PX26	Stainless Steel	8	
13	Washer	NDA-PX21	Carbon Steel	8	
		NDA-PX22	Stainless Steel	8	
14	Outlet Manifold	NDA-PC66	Aluminum	1	
		NDA-PC72	Stainless Steel	1	
15	Ball (31.75)	93278-2	Nitrile	4	
		93278-3	viton	4	
		93278-4	PTFE(white)	4	
		93278-C	PU	4	
		92408	Stainless Steel	4	
		93278-A	Santoprene	4	
16	O Ring	NDA-PS77	Nitrile	4	
		NDA-PS78	Viton	4	
		NDA-PS79	PTFE	4	
17	Seat	NDA-PE69	Aluminum	4	
		NDA-PE71	Stainless Steel	4	
		NDA-PE66	Polypropelene	4	
18	Inlet Manifold	NDA-PC67	Aluminum	1	
		NDA-PC73	Stainless Steel	1	
19	Nut	PX11	Carbon Steel	16	
		PX12	Stainless Steel	16	
20	Plastic Cap	NDA-PU01		2	
21	Plastic Cap	NDA-PU02		1	
22	Plug	NDA-PN107	Stainless Steel	2	
		NDA-PN108	Stainless Steel	2	